

## Replacing the spare-part no. 164865 electronic unit Installation in the EEB 6800.0

The same electronics unit is used for the EEB 6800.5 and the EEB 6800.0. However, new parameters will need to be set when installing the unit in the EEB 6800.0.

The procedure is as follows:

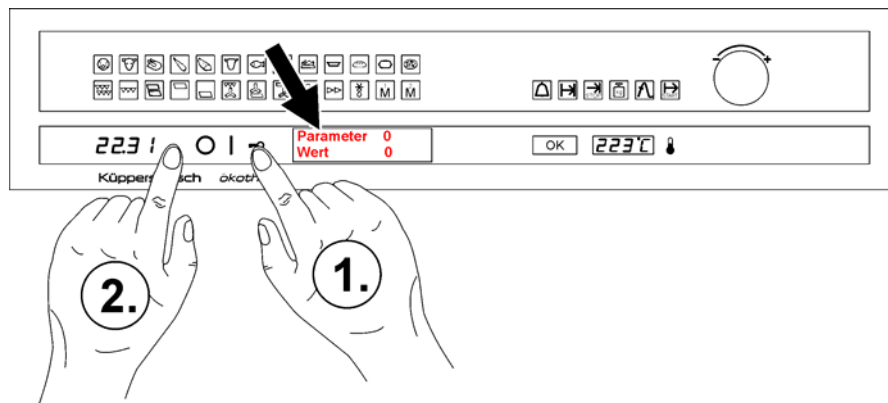

First of all press the button for the child safety lock and then immediately press the concealed "set clock" button, located between the clock and the "0" off button, for a little longer. The display will show: PARAMETER: 0 and SETTING: 0.00.

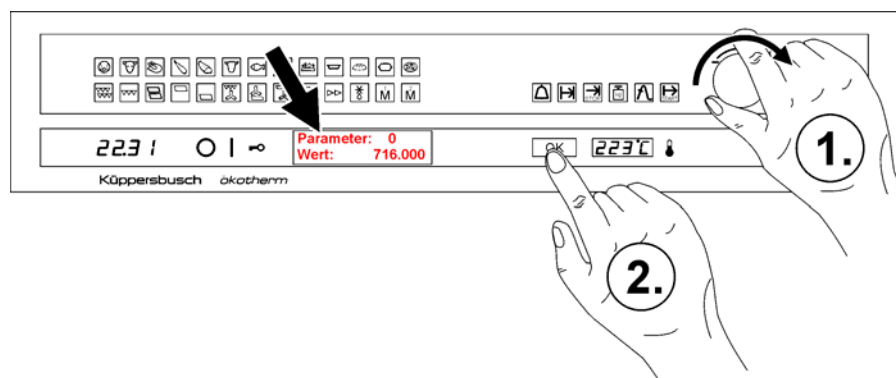

Turn the dial knob until the display shows SETTING: 716.000 and then confirm by pressing OK.

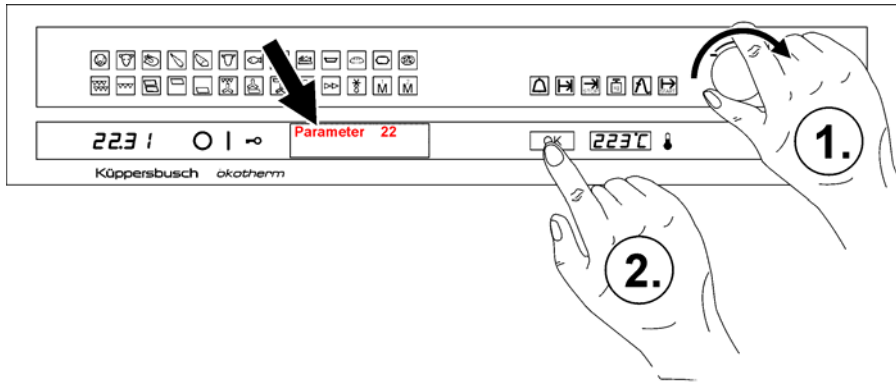

Turn the dial knob until the display indicates PARAMETER: 22 and press OK to confirm. The display will show: PARAMETER: 22 GeType and SETTING: 6810.00 (or another setting).

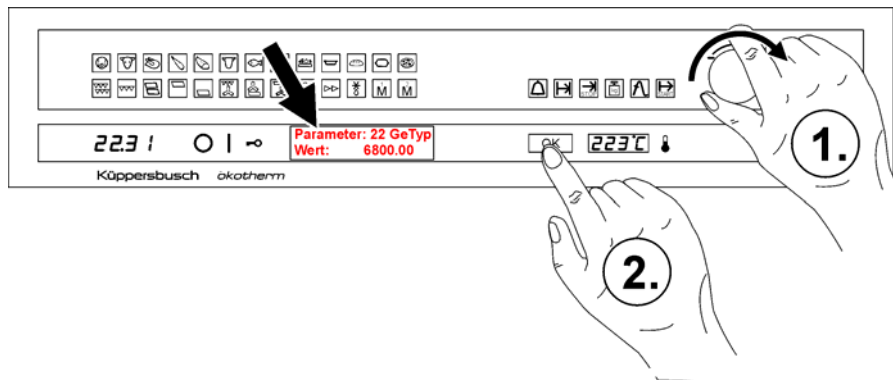

Turn the dial knob until the display shows SETTING: 6800.00 and press OK to confirm.

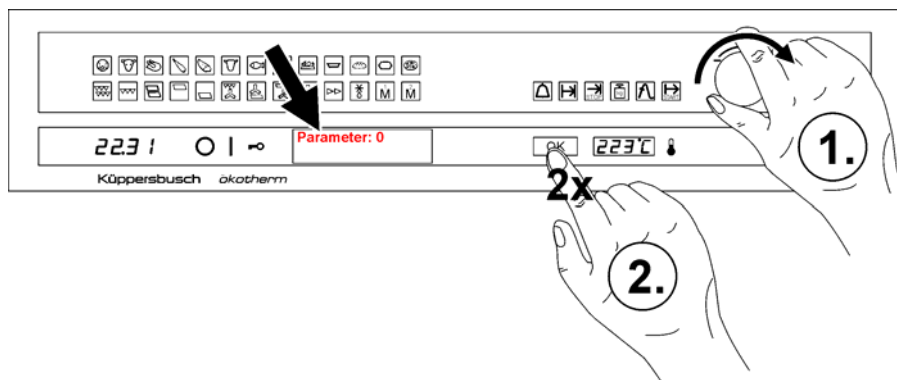

Turn the dial knob until the display shows PARAMETER: 0 and press OK twice to confirm.