

## Replacement of the EKDG 6800.OM supply pump

In the event of a supply pump defect, the complete pump is to be replaced with the customer service supply pump set (spare-part no. 565124):

1. Remove the two top L-B1 screws (P10032) (**Fig. 1**).
2. Remove the supply pump (**Fig. 1**).
3. Install the pump fixtures pre-assembled as in **Fig. 2** and fasten with the L-B1 screws which had been removed.
4. Insert the ELS 10 supply pump (spare-part no. 566385) (**Fig. 3**) between the two suspension elements (566386). To ensure that the pump is properly installed, make sure that the device to protect an excessive rise in temperature points towards the inside of the appliance.
5. Replace the old silicone hose (spare-part no. 565114) with the braided silicone hose contained in the set (spare-part no. 527842) (**Fig. 1**).
6. Put the adapter cable and the ground wire included in the set onto the supply pump (**Fig. 4**).  
Connect the adapter cable to the appliance cable. Remove the ground wire from the evaporator and connect the multiple plug. Connect the ground wire of the supply pump and the ground wire which was removed to the multiple plug (**Fig. 1**).

**The customer service set (spare-part no. 565124) comprises the following parts:**

No.	Article
1	Pump fixtures, pre-assembled
1	ELS 10 supply pump
1	Silicone hose, unbraided
1	Modification instructions
1	Multiple plug
1	Yellow/green wire (earthing)
1	Cable harness adapter supply pump

Fig. 1

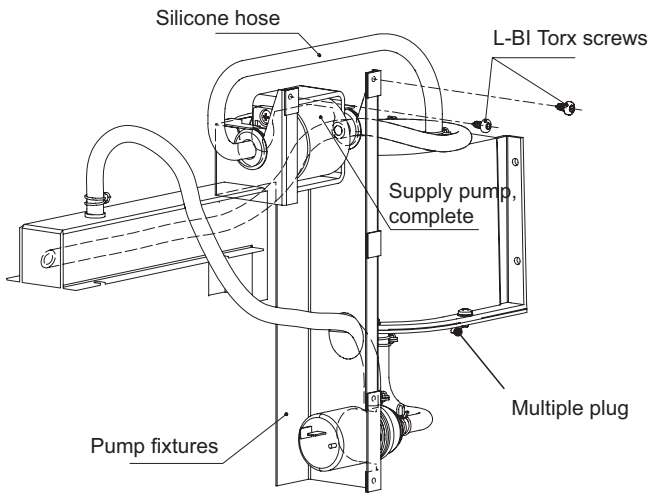

Fig. 2

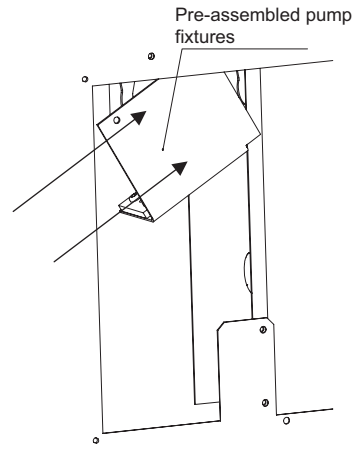

Fig. 3

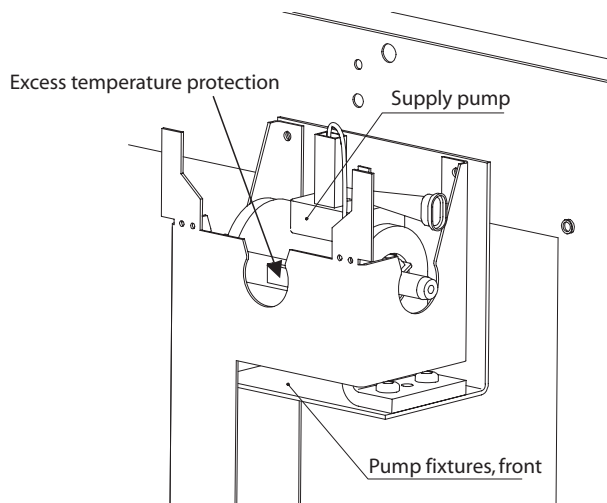

Fig. 4

