

### Self-centring Rinse Filter

#### *DW New structure - electromechanical, electronic appliances and Itronic*

Starting in September 2000 (serial number 037...) a new self-centring rinse filter has been installed gradually in all new dishwasher models (60 cm; New structure). The modification consists of a sliding conduit integrated in the inner part of the filter making the automatic self-centring in the fastening of the water collector possible.

This new system is therefore useful for the operator as he does not have to find the correct position to clasp the filter when reinserting the cleaning filter after it has been removed.

#### **Indications for the Customer Service:**

For the Customer Service three sets with spare filter are available (one for each type of dishwasher), which can be used for all dishwashers which have been manufactured before the modification and have been constructed with the old components.

Visible heating element with piping

Hidden heating element

Concerned components

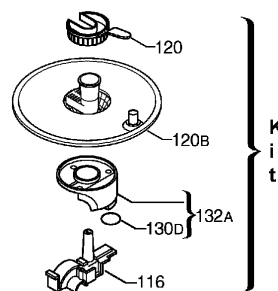
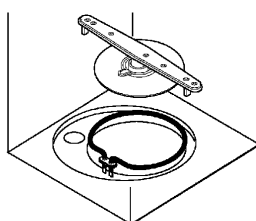
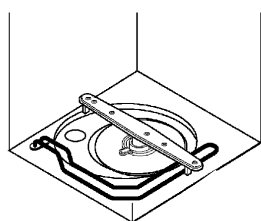

- The old components labelled 116, 132A and 120B **cannot** be replaced individually by the new ones but **only in total**.

**Table**

Dishwasher type	Auger	Filter set
<i>Electromechanical /Itronic</i> Visible heating element with piping	434594 (Colour GREY)	427023
<i>Electromechanical /Itronic</i> Hidden heating element	(Colour GREEN)	434889
<i>Electronic</i> Hidden heating element	(Colour WHITE)	434890