

Responsible: Dieter Rutz  
Date: 14.08.2014

Tel.: (0209) 401 733  
Fax: (0209) 401 743

---

## Drain pump blockages

### Description

---

It is possible for drain pumps from manufacturer Leili produced before 24.05.2013 to become jammed.

### Solution

---

1. Identify the drain pump you have by comparing the data label with those below. The later pumps also have a support bracket.

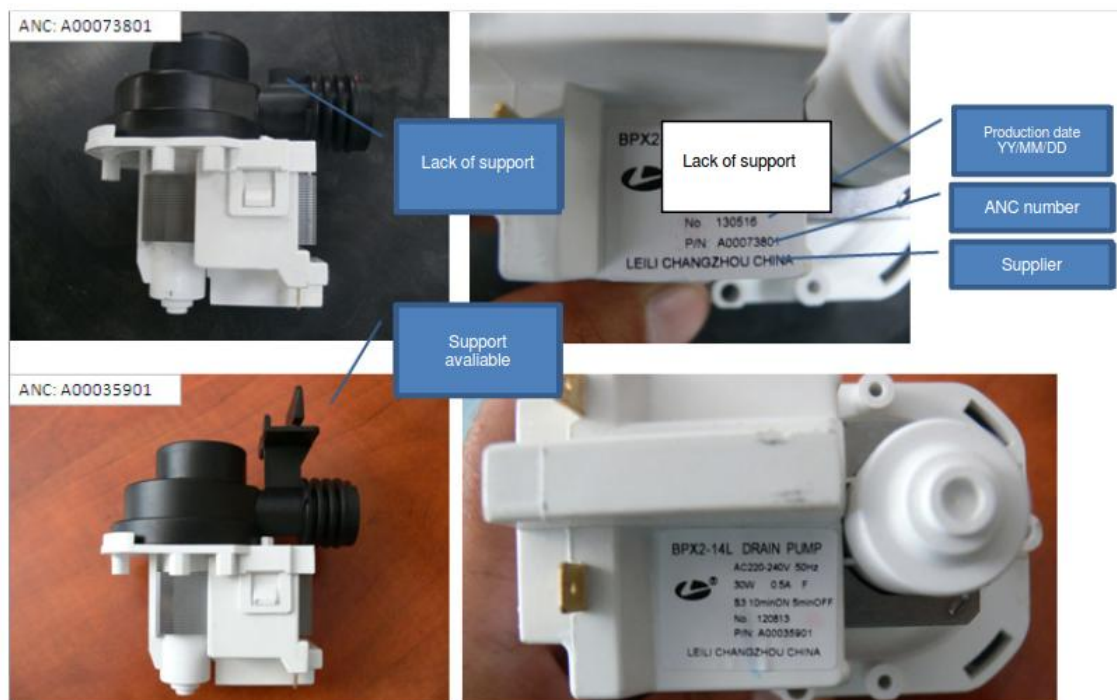

2. Replace with a new one produced after 24.05.2013. Do not unblock the pump, replace with a new one! Specific part numbers can be located on TDS for the model you have.

### Models involved

---

All PNCs.