

Responsible: Uwe Laarmann
Date: 04.04.2002

Phone: (0209) 401 732
Fax: (0209) 401 743



IK 458.2-4T

Formation of ice in the freezer compartment battery evaporator

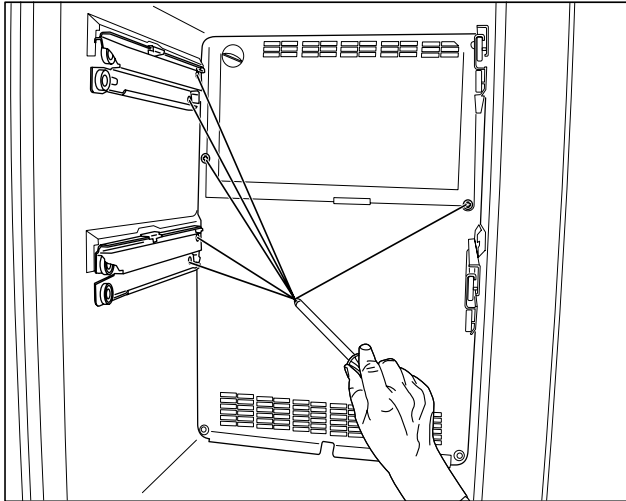

Loosen the screws and remove the two guide rails on one side.

Then loosen the screws on the back wall and swing it out.

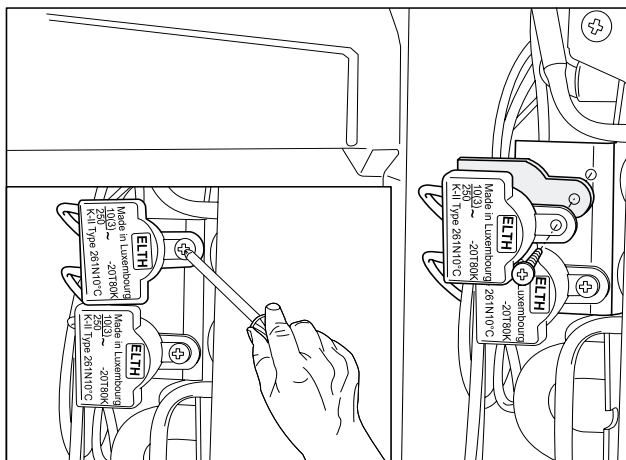

Loosen the defrost thermostat switch (upper thermostat).

Place a 2-3 cm thick small plastic plate (at least as big as the thermostat switch) under the defrost thermostat switch and screw both onto the fitting plate again with a relatively long Nirossta screw.

Attention! The screw should not be too long, since this could destroy the battery evaporator located behind.

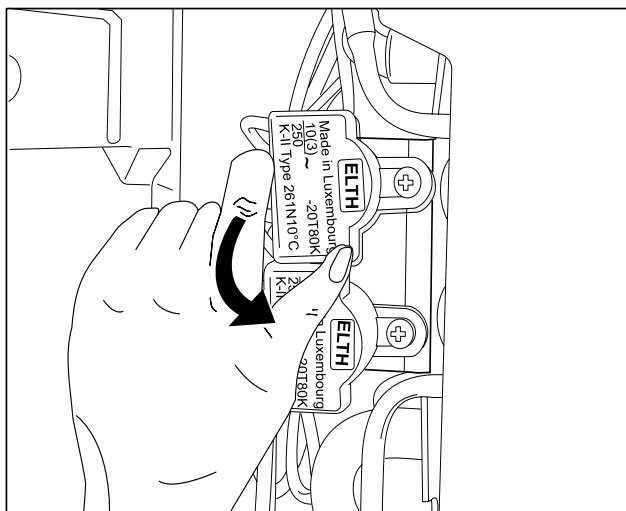

Bend the fitting plate, on which the defrost thermostat switch is mounted, slightly forward so that the thermostat switches are not in the direct air current of the filament resistance of the evaporator.

Re-install the back wall and the two guide rails and fix