

Installation of Charcoal Filters D4C

Introduction

As a result of the improvement of the new charcoal filters D1C on hoods produced by Portinox, the installation of the filters mentioned before has been modified in the models manufactured from September 2009. The main advantage of this improvement is that:

1. It can coexist with the current installation mode of D1C charcoal filters.
2. It becomes easier to install /substitute charcoal filters in all hoods, especially in hoods with very limited space.



This change does not mean the incompatibility with previous models. Nonetheless it will be incompatible with new products developments in the future (e.g.: D1C charcoal filters may not be compatible with new cooker hoods in the future)

Please note that previous versions of this technical note should not be in use any longer as they have been superseded.

Product changes explanation

The above mentioned change will affect the models and components in the table below:

Filter Type	Model Name	Recirculation Kit Type	Recirc. Kit Teka Code
D1C Teka Code: 61801236 EAN 13 Code: 8421152708293 	DQ 90	SET 1/L	40490109
	DR 90	SET 1/B	40490101
	DS 70	SET 1/C	40490103
	DS 90	SET 1/C	40490103
	DS Isla	SET 1/D	40490104
	DT 90	SET 1/C	40490103
	DV 80	SET 1/K	40490108
	DX 90	SET 1/H	40490018
	DX Isla	SET 1/I	40490019
	DY 110	SET 1/C	40490103
	DY 70	SET 1/C	40490103
	DY 90	SET 1/C	40490103
	NC 90	SET 1/C	40490103
	NC1 90	SET 1/C	40490103
	ND Alada 70	SET 1/C	40490103
	ND Alada 90	SET 1/C	40490103
ND Alada Isla	SET 1/E	40490105	

Instead of D1C charcoal filters, new recirculation kits in cooker hoods produced after September 2009 will be provided with D4C charcoal filters:

CODE	DESCRIPTION	CIP	EAN13
61801262	CHARCOAL FILTER D4C	7019	8421152070192

Up to now, they will be compatible with D1C charcoal filters. Therefore D1C charcoal filters can be installed in the current cooker hoods in the market. In the future it will be advised when D1C charcoal filters will be not compatible with new cooker hoods models.

New components operation

The new installation of the charcoal filters do not affect the current general features and certificate status of the above mentioned decorative cooker hoods.

The introduction of this improvement does not affect the operation of the hoods; it just affects the charcoal filter installation. Please find below the pictures, the explanation of the old installation and the installation of the new charcoal filter.

“OLD” installation of D1C charcoal filter

As mentioned above, until now the installation of the D1C charcoal filter depended on the delivery of specific plastic supports with the recirculation kits.

Taking into consideration that cooker hoods produced before May 2009 may still need these plastic supports, all recirculation kits will always include these plastic supports.

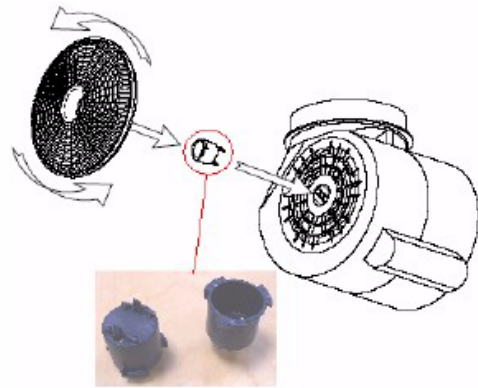

“NEW” installation of D4C charcoal filter

With the new installation mode, the D4C charcoal filter can be fixed directly to the cooker hoods motor from bellow. Therefore some steps need to be taken:

1. Firstly, a sealing cap needs to be placed in the middle of the charcoal filter.
2. Secondly, the charcoal filter (D4C) is inserted from bellow to the motor and ...

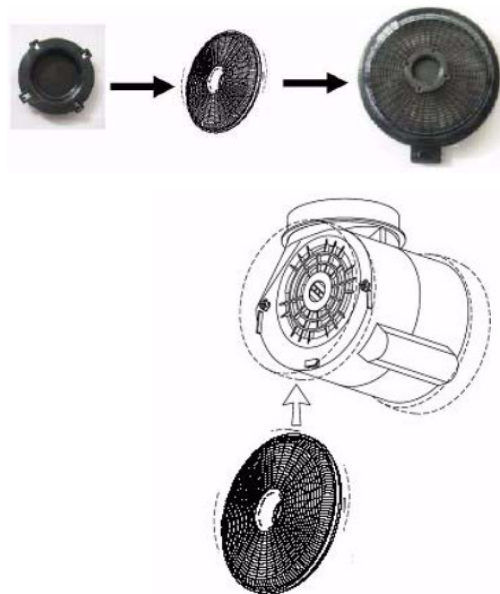

3. clipped into de sides of the motor.



Find below the details of the new grid and filter:

